

**JPHC**   
PRIVATE LIMITED

CREATING JOYFUL  
MEMORIES TOGETHER



**JP JASMINE**

— From Our Heart to Your Home —

2, & 3 BHK PREMIUM RESIDENTIAL FLATS  
@ HOSKOTE, BENGALURU.

[www.jphousing.in](http://www.jphousing.in)

WELCOME TO JP JASMINE APARTMENTS  
A SYMPHONY OF LUXURY AND COMFORT



Luxury and comfort come together in perfect harmony at JP Jasmine Apartments. From elegant interiors and well-planned layouts to thoughtfully curated amenities, every detail is crafted to enhance your lifestyle. The architecture embodies timeless sophistication, while modern conveniences add ease to everyday living. More than just a home, it is a refined living experience defined by elegance, functionality, and lasting value.





Your Gateway to Modern Living



JP Jasmine Apartments welcomes you to a lifestyle where modern design, thoughtful planning, and everyday convenience come together. Located in the rapidly growing hub of Hoskote, this community offers a seamless blend of urban connectivity and serene surroundings. From premium amenities to intelligently designed homes, every detail reflects the needs of today's dynamic lifestyle. Step into a space that opens doors to comfort, convenience, and a future-ready way of living.





MASTER PLAN  
LEGEND

- 01 ENTRY & EXIT
- 02 LANDSCAPE GARDEN - 1
- 03 KIDS PLAY AREA
- 04 GAZEBO
- 05 JOGGING / WALKING TRACK
- 06 LANDSCAPE GARDEN - 2
- 07 ELDER'S SEATING PARK
- 08 DRIVE WAY
- 09 SWIMMING POOL

<b>68</b> PREMIUM FLATS	<b>RERA</b> REGISTERED
<b>STILT+G+3</b> FLOOR	<b>BMRDA</b> APPROVED PROJECTS

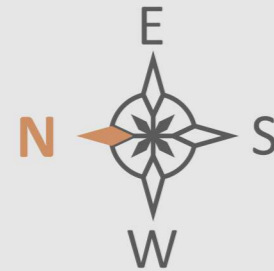

**JP JASMINE**

From Our Heart to Your Home

WELL-PLANNED SPACES.  
SEAMLESS LIVING.  
EXCEPTIONAL LIFESTYLE



JP JASMINE AMENITIES & FEATURES

- |                       |                          |
|-----------------------|--------------------------|
| Modern Gym            | Jogging Track            |
| Kids Play Area        | Elders Seating Parks     |
| Landscape Parks       | Rainwater Harvesting     |
| Multi Purpose Hall    | Generator Power Backup   |
| Swimming Pool         | Round The Clock Security |
| Gazebo                | CCTV Surveillance        |
| Tranquil Green Spaces | Automatic Lifts          |
| Wide Driveways        |                          |

TYPICAL FLOOR PLAN

AREA STATEMENT IN SFT

F NO.	01	02	03	04	05	06	07	08	09	10	11	12	13	14	15	16	17
AREA	1015	1260	1260	1260	1050	975	1010	1010	1030	1325	1275	1275	1275	1275	1275	1275	1015
TYPE	2BHK	3BHK	3BHK	3BHK	2BHK	2BHK	2BHK	2BHK	2 BHK	3BHK	3BHK	3BHK	3BHK	3BHK	3BHK	3BHK	2 BHK
FACING	WEST	NORTH	NORTH	NORTH	NORTH	WEST	NORTH	NORTH	EAST	EAST	EAST	EAST	EAST	EAST	EAST	EAST	EAST

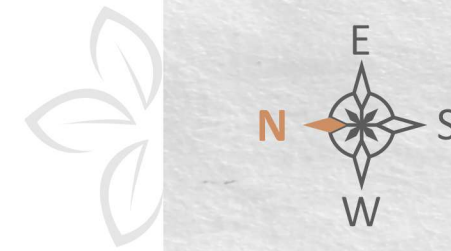

EXPLORE SPACES THAT FIT YOUR LIFE PERFECTLY.

Discover thoughtfully designed homes at JP Jasmine Apartments where every space is crafted to fit your lifestyle perfectly. Whether you're seeking cozy comfort or spacious living, our floor plans offer flexibility and functionality to meet your unique needs. Experience a home that grows with you, designed to support your daily routine and future aspirations.

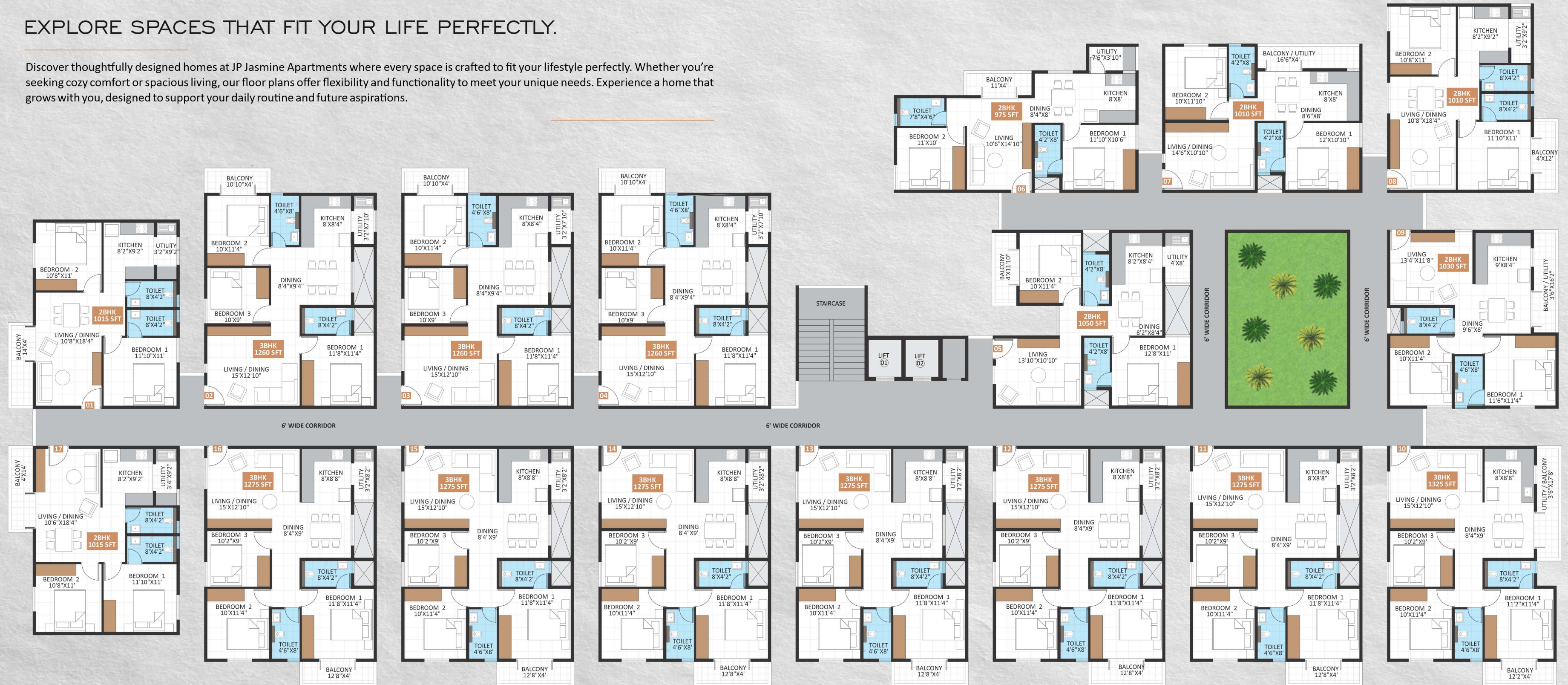

DESIGNED FOR RELAXATION.  
BUILT FOR ENJOYMENT.



Every element at JP Jasmine Apartments is thoughtfully designed to enhance your relaxation and comfort. From serene green spaces to meticulously crafted living areas, the community provides a peaceful retreat from the city's hustle and bustle. Built with your enjoyment in mind, premium amenities and recreational facilities ensure each day is filled with joy, wellness, and quality moments with loved ones. Discover a home where relaxation and enjoyment come naturally.





JP Jasmine Apartments is your gateway to modern living, combining contemporary design with unmatched comfort. Designed for today's urban lifestyle, the homes feature spacious layouts and premium amenities. Enjoy seamless connectivity to key city hubs while basking in a tranquil environment. Discover a community that elevates your lifestyle and embraces the future of living.





**STRUCTURE:**  
Earthquake protected RCC framed structure.



**WALLS:**  
6" Solid concrete blocks for external and  
4" Solid concrete blocks for internal walls.



**PLASTERING:**  
Sponge finish for external walls  
and lime finish for internal walls.



**DOORS:**  
MAIN DOOR: Engineered wood frame & Veneered  
Flush Door, polish finish with fittings.  
OTHER DOORS: Engineered wood frames and  
Laminated Flush doors with SS fittings.



**KITCHEN:**  
Provision for aquaguard, Sink Tap and electrical points.



**PAINTING:**  
Asian Tractor Emulsion or equivalent company paint  
for internal walls, Asian Apex for external walls,  
Asian Ace for ducts and Asian enamel paint for doors.



**FLOORING:**  
Vitrified / GVT tiles in all bedrooms, living hall,  
anti-skid tiles in bathrooms, utility and balcony.



**GENERATOR:**  
Stand by generator for lifts, pumps, common  
area lighting and 0.5 KW power backup to each flat  
during power failure.

## COMMITTED TO QUALITY. DRIVEN BY EXCELLENCE.

JP Group has successfully delivered over 10 residential projects, consistently attaining high customer satisfaction and trust. Renowned for our innovative design approach and commitment to sustainable practices, we have been recognized with multiple industry awards. Our focus remains on building vibrant, thriving communities while consistently providing exceptional value to our clients.

# JPHC

PRIVATE LIMITED

### PREMIUM & QUALITY SPECIFICATIONS



**WINDOWS:**  
2.5 track UPVC / Aluminium window frames  
and glass shutters along with mosquito mesh.



**TOILETS:**  
Glazed tiles dado upto 7 Feet in toilets will be  
provided. Provision for geyser in all toilets,  
sanitary ware of Grohe, American Standard or  
equivalent will be provided.



**WATER SOFTENER PLANT:**  
Water softener plant will be provided.



**LIFT:**  
2 Nos of 6 Passenger Automatic lifts with Standard  
make (Kone or Schindler or equivalent make).



**ELECTRICAL WORK:**  
Concealed copper wiring and electrification with adequate  
light & fan points in all rooms. TV points will be provided  
in the hall and master bedroom. A/C Points provision in Master  
bed rooms with Anchor or Schneider or Legrand or equivalent  
switches. Switch and socket for fridge, washing machine,  
microwave oven, exhaust fan, mixer, and geyser will be provided.  
MCB for safety.



**ELECTRICAL CHARGING PROVISION:**  
Electrical charging point provision for Two & Four  
wheeler EV vehicles.



**WATER SUPPLY:**  
Adequate borewell water supply.



**STAIRCASE AND CORRIDORS:**  
Granite or vitrified / GVT tiles.

### OUR MILESTONE PROJECTS @HOSKOTE, BENGALURU



# YOUR URBAN RETREAT IN THE HEART OF HOSKOTE

JP Jasmine Apartments perfectly combines peaceful green living with the conveniences of city life. Situated in the heart of Hoskote, it offers easy connectivity to key hubs like Whitefield, ITPL, and KR Puram. With spacious open areas and modern amenities, the community is designed for comfort and convenience.

## LOCATION PLAN ( NOT TO SCALE )

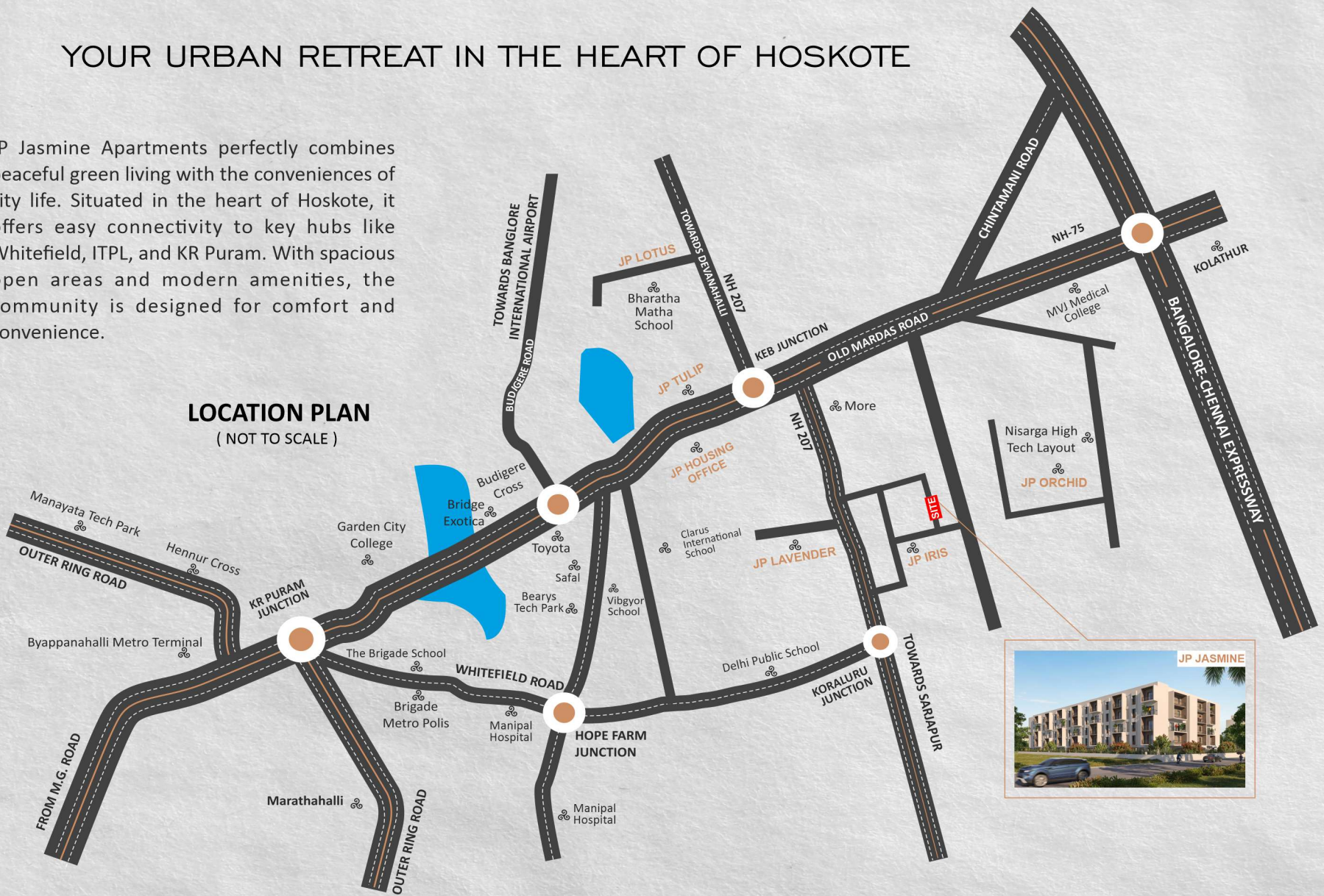

### IT COMPANIES

- + Bearys Global Research Triangle
- + Bluestone IT Park
- + HM Tech Park
- + ITPL
- + Sigma Soft Tech Park
- + Kalyani Tech Park
- + Narsapura & Vemgal Industrial Area

### SCHOOLS

- + Caldwell Academy School
- + Fatima English High School
- + New Horizons School
- + Capstone International School
- + VIBGYOR School
- + Clarus International School
- + Delhi Public School

### HOSPITALS

- + Chaitanya Medical Center
- + Silicon City Hospital
- + Srinivasa Hospital
- + OVUM Women's & Children's Hospital
- + GEF Eye Care Hospital
- + Mission Hospital
- + MVJ Medical College & Hospital

### OTHER IMPORTANT PLACE

- + ORION Mall
- + Hoskote KIADB Industrial Area
- + KR Puram Railway Station
- + Forum Value Mall
- + Kadugodi Metro Station
- + Byapanahalli Metro Station
- + Bengaluru International Airport

#### Developers

**JPHC**  
PRIVATE LIMITED

Site No. 32 & 33, 4th Floor,  
Near Bajaj KTM Showroom,  
AIR Extension, NH-75, Hoskote Town,  
Bengaluru Rural - 562 114.

#### Site Address

**JP JASMINE**  
From Our Heart to Your Home

Sy No: 204,  
Near Caldwell Academy School,  
Kammavari Nagara, Hoskote,  
Bengaluru - 562 114.

#### Contact Details

**+91 99000 89685**  
**+91 99000 92963**

E: [sales@jphousing.in](mailto:sales@jphousing.in)  
W: [www.jphousing.in](http://www.jphousing.in)